

# HORSE RAIL® – BASIC INSTALLATION GUIDE

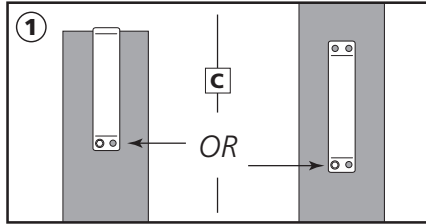

- Attach brackets to line posts
- A)** Find the center tangent of each post - this will reduce binding
  - B)** Use a tape measure or a marking board to locate and mark the top of each bracket - from the top down
  - C)** Attach Top Line Post Brackets and Line Post Brackets (one bottom hole only)

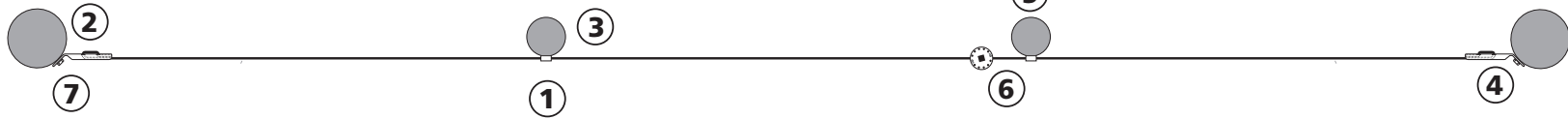
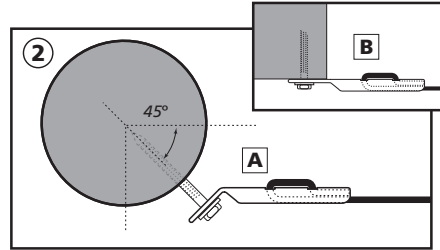

- Install rail onto selected end buckle and attach to end post
- A)** Pre-Bent 45° Attaching Buckle attach at a 45 degree angle leaving the lag screw partially out
  - B)** OPTION: Straight Attaching Buckle - for use on a flat surface such as a building - Note: tighten the lag screw
  - C)** **IMPORTANT: Do Not Overtighten!**

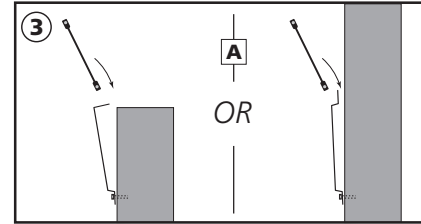

- Payout rail and insert into brackets
- To best protect the rail - Use either a "Payout Box" or an oversized spinning jenny
- A)** Lift and slide rail in place
  - B)** Align Brackets to right angle of rail - allowing for movement

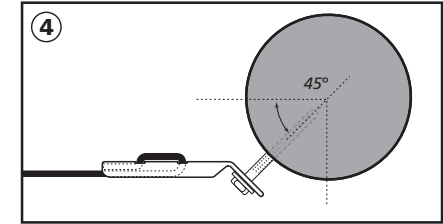

- Install other end of rail using the proper end buckle
- Tighten lag screw halfway
  - Leave sufficient length in rail to allow proper tensioning - see Step 6

Use a Joining Buckle to join two rail sections together

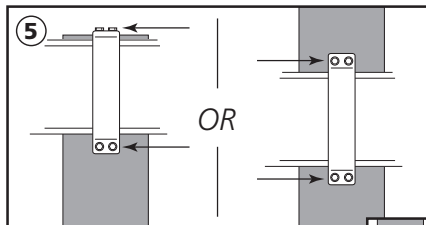

- Finish attaching all brackets to line and end posts
- Use four wide shoulder, hex head drive screws for each bracket
  - Bracket must be at right angle to rail - allowing for movement

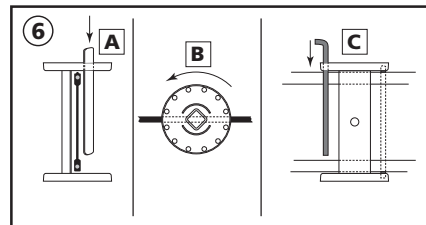
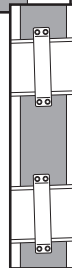

- Install Spooler and tension the fence
- For aesthetics - place Spooler 12" (305mm) min. from line post
- A)** Place Spooler on rail and slide "removable" hub piece into place
  - B)** Allow for one full rotation before becoming taut
  - C)** Place locking pins into pre-drilled holes, opposite each other, to stop the Spooler from unwinding

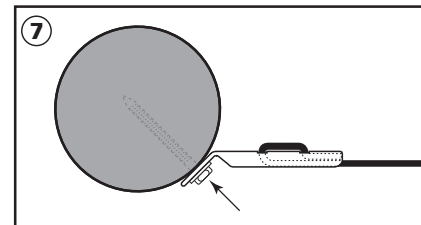

- Complete your fence installation by fully tightening the lag screws from Step 2 and Step 4 - this will also further tension the rail!
- **IMPORTANT: Do Not Overtighten!**

## HARDWARE AND ACCESSORIES

- BRACKET SCREWS:** Use Wide Shoulder #8 - 2" minimum; 5/16" (#8 - 50mm minimum; 8mm) Hex Head Drive Screws Only
- LAG SCREWS:** 1/2" x 4" thru 6" (12mm x 100mm thru 150mm)
- BENDING TOOL:** for Simplicity and Neatness The perfect tool for bending rail to the optimum shape and dimension
- LONG HANDLE RATCHETS:** Used for a "Two-Man" Installation Process!
- EXTENDED HANDLE RATCHETS:** Used for a "One-Man" Installation Process!

For More Details, Tips & Techniques on Building Fences,  
Please visit our website:  
[www.horserail.com](http://www.horserail.com)

**SAFETY FIRST: USE SAFETY EYE GLASSES AND GLOVES.**

